

VIBRATORY PLATES



SOLUTIONS THAT LAST



HARDEST HITTING, LONGEST LASTING

MBW's advancements in vibratory plates have revolutionized the field over the past 40 years.

MBW designs have doubled productivity, dramatically reduced maintenance and extended product life. The competition has been in continual catch-up mode. Today, MBW offers the industry's broadest range of high production, single direction plates. Performance and life expectations of MBW plates continue to define the state-of-the-art.



- Unsurpassed exciter quality including extra heavy duty housings, precision ground ductile eccentric shafts, oversized application matched bearings, oil mist lubrication system and custom lubricants to withstand high operating temperatures.
- Stress relieved steel tamping plates are crack resistant and provide years of useful service. Twice the strength and 45% more resistant to abrasion than cast iron tamping plates.
- Tough, custom designed centrifugal clutches.
- Application matched quality shock mounts and double isolated guide handles.
- Most importantly, each model offers a unique combination of frequency, centrifugal force, amplitude, and mass to provide the best possible results in terms of productivity and product life.

1400/1800 SERIES

1400 SERIES

The **1400** Series of vibratory plates are portable, economical and offer outstanding performance. Ideally suited for confined areas of sand and gravel, the GP1400 is capable of achieving lift depths of 10 inches (25 cm). The lightweight design, accompanied by intense vibration, allows the GP1400 to be used for placing interlocking paving stones. The removable handle allows for convenient transport in any vehicle. Roll cage and water tank standard equipment on AP1400 for asphalt applications.



AP1400
shown with roll cage
& water tank

1800 SERIES

The lightweight, highly portable **1800** Series of vibratory plates offers an economical alternative for small to medium soil applications. These plates are ideally suited for confined areas of sand and gravel and are capable of achieving lifts of up to 12 inches (30 cm). Available with either Honda or Robin engines and optional roll cage.

- Optional neoprene paving pad accessory for interlocking paving blocks
- One piece exciter with self cleaning open plate housing design



GP1800

SPECIFICATIONS	AP1400H	GP1400H	GP1800H	GP1800R
Engine	Honda GX120 4.0 hp (3.0 kw)	Honda GX120 4.0 hp (3.0 kw)	Honda GX120 4.0 hp (3.0 kw)	Robin EX130 4.5 hp (3.4 kw)
Operating Weight	149 lb (68 kg)	129 lb (59 kg)	136 lb (62 kg)	139 lb (63 kg)
Plate Size WxL	14 x 21 in (36 x 53 cm)	14 x 21 in (36 x 53 cm)	18 x 21 in (46 x 53 cm)	18 x 21 in (46 x 53 cm)
Centrifugal Force	1925 lbf (8.6 kN)	1925 lbf (8.6 kN)	2300 lbf (10.2 kN)	2300 lbf (10.2 kN)
Exciter Speed	5240 vpm	5240 vpm	4710 vpm	4710 vpm
Compaction Depth	up to 10 in (25 cm)	up to 10 in (25 cm)	up to 12 in (30 cm)	up to 12 in (30 cm)
Travel Speed	85 ft/min (26 m/min)	85 ft/min (26 m/min)	100 ft/min (30 m/min)	100 ft/min (30 m/min)
Compaction Area	5100 sqft/h (474 sqm/h)	5100 sqft/h (474 sqm/h)	9000 sqft/h (836 sqm/h)	9000 sqft/h (836 sqm/h)

() Metric Measurements.
Specifications subject to change without notice.

AP2000 SERIES

MBW's AP2000 Series is the only vibratory plate compactor specifically designed for asphalt applications. Frequency, amplitude, centrifugal force and mass are all established at optimal levels for maximum productivity on asphalt.



Further, the mechanical construction of the AP2000 is specific to this very demanding application. Stress relieved steel plate housings are crack resistant and provide long wear. Aluminum exciter housing dissipates heat rapidly and custom lubricants preserve bearing and seal integrity. The self cleaning plate prevents dirt build-up.

The GP2000 is a permutation of the AP2000 where frequency, amplitude, centrifugal force and mass are adjusted to provide optimal productivity in the compaction

of sands and gravel. The GP2000 is capable of achieving excellent densities on lifts of granular soils up to 14" (36 cm)*.

- Both units available with either Honda or Robin engines
- Optional neoprene paving pad accessory for interlocking paving blocks

* Clean sand, optimum moisture. MBW recommends that lifts not exceed 12".

SPECIFICATIONS	AP2000H	GP2000H	AP2000R*	GP2000R*
Engine	Honda GX160 5.5 hp (4.1 kw)	Honda GX160 5.5 hp (4.1 kw)	Robin EX13 4.5 hp (3.4 kw)	Robin EX13 4.5 hp (3.4 kw)
Operating Weight	AP2000H No Water 168 lb (76 kg) AP2000H Full Water 193 lb (88 kg)	165 lb (75 kg)	AP2000R No Water 168 lb (76 kg) AP2000R Full Water 193 lb (88 kg)	165 lb (75 kg)
Plate Size WxL	20x22 in (51x56 cm)	20x22 in (51x56 cm)	20x22 in (51x56 cm)	20x22 in (51x56 cm)
Centrifugal Force	2475 lbf (11 kN)	3250 lbf (14.5 kN)	2475 lbf (11 kN)	3250 lbf (14.5 kN)
Exciter Speed	4400 vpm	5050 vpm	4400 vpm	5050 vpm
Compaction Depth	up to 12 in (31 cm)	up to 14 in (36 cm)	up to 12 in (31 cm)	up to 14 in (36 cm)
Travel Speed	90 ft/min (27.4 m/min)	120 ft/min (36.6 m/min)	90 ft/min (27.4 m/min)	120 ft/min (36.6 m/min)
Compaction Area	8550 sqft/h (794 sqm/h)	10800 sqft/h (1000 sqm/h)	8550 sqft/h (794 sqm/h)	10800 sqft/h (1000 sqm/h)

* Also available is the AP2000R6 or GP2000R6 with a Robin EX17 6 hp engine.
() Metric Measurements.
Specifications subject to change without notice.

3550 & 3000-15 SERIES

3550

The GP3550 is a premium, high production compactor with life expectancy that runs to decades with reasonable maintenance. The deck features a full roll cage as standard equipment with provisions for a water tank for asphalt compaction on AP3550. The base plate is self-cleaning with an open sided plate design that allows material to flow out and away from the belt/pulley assembly during operation. Both models provide reduced hand/arm vibration, full roll cage protection, enhanced amplitude, faster travel speed and updated yet rugged appearance.



3000-15

The GP3000-15 Series is ideal for confined work areas, such as sidewalk, curb and gutter, and narrow trenches. This specialty plate is not a lightweight compactor. Its operating weight is over 200 lbs. (91 kg) and produces 3,550 lbs. (15.8 kN) of centrifugal force, compaction depths up to 16 in. (41 cm)*, and a travel speed of 120 ft./min (36.6 m/min.).



SPECIFICATIONS	GP3550H AP3550H	GP3550R* AP3550R*	GP3000-15H	GP3000-15R
Engine	Honda GX160 5.5 hp (4.1 kw)	Robin EX13 4.5 hp (3.4 kw)	Honda GX160 5.5 hp (4.1 kw)	Robin EX13 4.5 hp (3.4 kw)
Operating Weight	GP3550H 226 lb (103 kg) AP3550H-No Water 229 lb (104 kg) AP3550H-Full Water 254 lb (115 kg)	GP3550R 226 lb (103 kg) AP3550R-No Water 229 lb (104 kg) AP3550R-Full Water 254 lb (115 kg)	202 lb (92 kg)	204 lb (93 kg)
Plate Size WxL	21x22 in (53x56 cm)	21x22 in (53x56 cm)	16x20 in (41x51 cm)	16x20 in (41x51 cm)
Centrifugal Force	3550 lbf (15.8 kN)	3550 lbf (15.8 kN)	3550 lbf (15.8 kN)	3550 lbf (15.8 kN)
Exciter Speed	4400 vpm	4400 vpm	4400 vpm	4400 vpm
Compaction Depth	up to 18 in (47 cm)	up to 18 in (47 cm)	up to 16 in (41 cm)	up to 16 in (41 cm)
Travel Speed	110 ft/min (34 m/min)	110 ft/min (34 m/min)	120 ft/min (36.6 m/min)	120 ft/min (36.6 m/min)
Compaction Area	11000 sqft/h (1022 sqm/h)	11000 sqft/h (1022 sqm/h)	9600 sqft/h (890 sqm/h)	9600 sqft/h (890 sqm/h)

* Also available is the GP3550R6 or AP3550R6 with a Robin EX17 6 hp engine.
() Metric Measurements.
Specifications subject to change without notice.

* Clean sand, optimum moisture. MBW recommends that lifts not exceed 12".



1-800-6 78-5237

GP5500 / GP7000 SERIES

GP5500 SERIES

The **GP5500** Series of vibratory plates is a contractor favorite with its combination of superlative productivity (up to 130 ft/min) and mechanical reliability. This versatile compactor features a self-cleaning plate, one-piece exciter and base plate design, and is an especially good fit for mid to large sized commercial/industrial applications.

GP7000 SERIES

The **GP7000** Series is MBW's heavy hitter for mid-sized to large jobs with difficult soils and deep lifts of up to 30 in. (76 cm)*. Weighing 653 lbs. (296 kg) with low frequency and high amplitude, this hard working vibratory plate produces 7,900 lbs. (35.1 kN) of centrifugal force and outperforms walk-behind rollers on most granular applications. The GP7000 is easy to maneuver and isolates compaction force away from the operator. A central lifting bail provides easy lift and transport.



SPECIFICATIONS	GP5500H	GP5500R	GP5500Y	GP7000H	GP7000Y
Engine	Honda GX270 9 hp (6.7 kw)	Robin EX27 9 hp (6.7 kw)	Yanmar 6 hp (4.5 kw)	Honda GX390 13 hp (9.7 kw)	Yanmar 10 hp (7.5 kw)
Operating Weight	279 lb (127 kg)	293 lb (133 kg)	297 lb (135 kg)	653 lb (296 kg)	686 lb (311 kg)
Plate Size WxL	23 x 24 in (58 x 61 cm)	23 x 24 in (58 x 61 cm)	23 x 24 in (58 x 61 cm)	26 x 30 in (66 x 76 cm)	26 x 30 in (66 x 76 cm)
Centrifugal Force	5800 lbf (25.8 kN)	5800 lbf (25.8 kN)	5800 lbf (25.8 kN)	7900 lbf (35.1 kN)	7900 lbf (35.1 kN)
Exciter Speed	4700 vpm	4700 vpm	4700 vpm	2800 vpm	2800 vpm
Compaction Depth	up to 20 in (51 cm)	up to 20 in (51 cm)	up to 20 in (51 cm)	up to 30 in (76 cm)	up to 30 in (76 cm)
Travel Speed	130 ft/min (39.6 m/min)	130 ft/min (39.6 m/min)	130 ft/min (39.6 m/min)	100 ft/min (30.5 m/min)	100 ft/min (30.5 m/min)
Compaction Area	14950 sqft/h (1390 sqm/h)	14950 sqft/h (1390 sqm/h)	14950 sqft/h (1390 sqm/h)	13000 sqft/h (1210 sqm/h)	13000 sqft/h (1210 sqm/h)

* Clean sand, optimum moisture.
MBW recommends that lifts not exceed 12".

() Metric Measurements.
Specifications subject to change without notice.

The Heart and Soul

of our machines are their rugged, hard hitting exciters. Our exciters include an extra **heavy duty housing** with maximum surface area for heat dissipation and strength, and **ductile eccentric shafts** that are precision ground to preserve bearing tolerances. The **bearings are carefully matched** in design, tolerance and type for high temperature vibratory applications and **custom lubricants** with elevated flash points are used. Nowhere in the world will you find a stronger or more dependable driving force behind a vibratory plate.

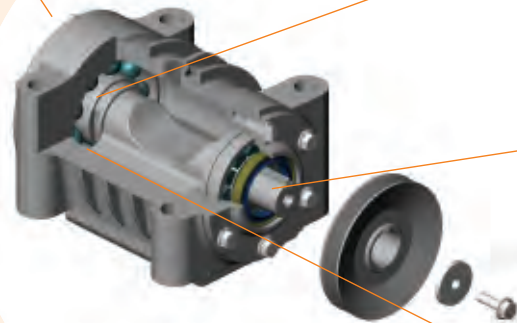

Heaviest Bearings

in the industry to maintain performance and minimize down time

Precision Machined Shaft

to maintain critical bearing tolerances

Custom Lubricants

for high temperature applications

GPR65, GPR68, GPR77 MECHANICAL SHIFTING REVERSIBLES

The **GPR 65, 68 and 77 Series** are compact reversible plates ideal for narrow trenches and confined areas.

Heavy Duty Shifting

The heavy duty mechanical shifting mechanism allows for directional changes at full speed. Endurance testing was terminated at 400,000 shifts without system failure – the best result MBW (and very likely any manufacturer) has ever achieved on a reversible plate shifting design.



GPR77

With eight years of exceptional maintenance history behind models GPR65 and GPR68, MBW now introduces a similar mechanical shifting design on a larger reversible. The GPR77 is a 400 pound reversible plate producing 7775 pounds of CF at 4725 vpm. The simple yet reliable shifting design lowers acquisition cost, is low maintenance and provides a geo-technical benefit in its ability to shift travel direction at constant speed. Shifting travel direction at constant speed greatly enhances the user's probability of achieving uniform density and stiffness over the area being compacted (see www.mbw.com for "GPR77-Mechanical or Hydraulic Shifting")

The GPR77 produces an amplitude of .064 inches, travel up to 85ft/min and handles all types of essentially granular soils.



The GPR 65, 68 and 77 are also high production plates. Travel speeds to 95 ft/min are achieved with good compaction conditions and the plates move with ease over irregular lift surfaces. Head-to-head competitive demonstration quickly establishes the comparative productivity benefits of the GPR65, GPR68 and GPR77.



SPECIFICATIONS	GPR65	GPR68	GPR77H	GPR77D
Engine	Honda GX160 5.5 hp (4.1 kw)	Honda GX160 5.5 hp (4.1 kw)	Honda GX270 9 hp (6.7 kw)	Hatz 1B20 4.6 hp (3.4 kw)
Operating Weight	325 lb (148 kg)	330 lb (150 kg)	397 lb (180 kg)	399 lb (181 kg)
Plate Size WxL	15 x 20 in (38 x 51 cm)	18 x 20 in (46 x 51 cm)	22 x 26 in (56 x 67 cm)	22 x 26 in (56 x 67 cm)
Centrifugal Force	6000 lbf (27 kN)	6000 lbf (27 kN)	7775 lbf (35 kN)	7775 lbf (35 kN)
Exciter Speed	4400 vpm	4400 vpm	4725 vpm	4725 vpm
Compaction Depth*	Up to 22 in (56 cm)	Up to 22 in (56 cm)	Up to 22 in (56 cm)	Up to 22 in (56 cm)
Travel Speed	95 ft/min (29 m/min)	95 ft/min (29 m/min)	86 ft/min (26 m/min)	86 ft/min (26 m/min)
Compaction Area	7125 sqft/h (662 sqm/h)	8550 sqft/h (794 sqm/h)	9460 sqft/h (872 sqm/h)	9460 sqft/h (872 sqm/h)

() Metric Measurements.

Specifications subject to change without notice.

* Clean sand, optimum moisture. MBW recommends that lifts not exceed 12".

GPR78, GPR99 & GPR135 HYDRAULIC REVERSIBLE PLATE COMPACTORS BY ATES

MBW's hydraulic shifting reversible plates solve maintenance problems that have long plagued this product type. MBW exciter systems are vented to allow for discharge of heat generated air pressure before damage to shifting mechanism seals occurs. Worn shifting seals are readily serviced from the outside of the exciter assembly (US Patent, International Patents Pending), eliminating the complicated process of opening and exposing the exciter assembly for service purposes. Maintenance is simplified, service time is reduced dramatically and the precision exciter assembly is not exposed to contamination.



All MBW hydraulic reversibles are easy to maneuver, featuring forward and reverse travel as well as spot compaction. Powered by either Honda gas engines or Hatz diesels, these reversibles have plenty of power to tackle the toughest compaction applications.

MBW advises users to carefully consider which type of compactor best fits the job. If there is sufficient room to maneuver a single direction plate, productivity, cost and maintenance favor the single direction unit. But where maneuverability is key, reversible plates are the answer.

- Forward or reverse, infinitely variable travel plus spot compaction
- Patented lower maintenance hydraulic shifting mechanism
- Optional extension plates for variable plate widths
- Gas and diesel engine options
- Lifting bails for ease in handling
- Higher amplitudes than competitive models, increased travel speed and climbing ability
- Full roll cage protection
- Simple, convenient, safe controls at operator's position



SPECIFICATIONS	GPR78H	GPR78D	GPR99H	GPR135DE	GPR135H
Engine	Honda GX270 9 hp (6.7 kw)	Hatz 1B30 6.8 hp (5.1 kw)	Honda GX340 11 hp (8.2 kw)	Hatz 1B40 10.2 hp (7.6 kw)	Honda GX390 13 hp (9.7 kw)
Fuel	Gas	Gas	Gas	Diesel	Gas
Operating Weight	522 lb (237 kg) <i>No Wings</i> 562 lb (255 kg) <i>3" Wings</i>	567 lb (257 kg) <i>No Wings</i> 607 lb (275 kg) <i>3" Wings</i>	775 lb (352 kg) <i>No Wings</i> 860 lb (390 kg) <i>6" Wings</i>	882 lb (400 kg) <i>No Wings</i> 968 lb (439 kg) <i>6" Wings</i>	825 lb (374 kg) <i>No Wings</i> 911 lb (413 kg) <i>6" Wings</i>
Plate Size WxL	17.7 x 32.3 in (45 x 82 cm)	17.7 x 32.3 in (45 x 82 cm)	19.7 x 32.3 in (50 x 82 cm)	19.7 x 37.3 in (50 x 95 cm)	19.7 x 37.3 in (50 x 95 cm)
Centrifugal Force	7875 lbf (35 kN)	7875 lbf (35 kN)	9900 lbf (44 kN)	13500 lbf (60 kN)	13500 lbf (60 kN)
Exciter Speed	4080 vpm	4080 vpm	3840 vpm	3840 vpm	3840 vpm
Compaction Depth	up to 22 in (56 cm)	Up to 22 in (56 cm)	Up to 28 in (71 cm)	Up to 28 in (71 cm)	Up to 28 in (71 cm)
Travel Speed	82 ft/min (25 m/min)	82 ft/min (25 m/min)	80 ft/min (24 m/min)	76 ft/min (23 m/min)	78 ft/min (24 m/min)
Compaction Area	7260 ft ² /hr (675 m ² /hr)	7260 ft ² /hr (675 m ² /hr)	7880 ft ² /hr (732 m ² /hr)	7490 ft ² /hr (696 m ² /hr)	7680 ft ² /hr (713 m ² /hr)

() Metric Measurements. Specifications subject to change without notice.

* Clean sand, optimum moisture. MBW recommends that lifts not exceed 12".



MBW Inc.
 250 Hartford Road • P.O. Box 440
 Slinger, Wisconsin • 53086-0440 • USA
 800-678-5237
 262-644-5234
 Fax: 262-644-5169
 E-mail: mbw@mbw.com • Website: www.mbw.com

MBW UK Ltd.
 Units 2 & 3 Cochrane Street
 Bolton BL3 6BN • England UK
 44 (0) 1204 387784
 Fax: 44 (0) 1204 387797

E-mail: mbwuk@btinternet.com • Website: www.mbw.com

AUTHORIZED DISTRIBUTOR